

Work Manual

— M-1610-00SF —



NINGBO WANGTONG LOCKS CO.,LTD.

How to operate

Lock & unlock



➤ Unlock

- 1 -To verify your fingerprint on lock for about 1 second, Buzzer gives out a long di... sound , the unlocking indicator light  is on
- 2-Turn the knob within 3s to open the lock

➤ Lock

Rotate the knob to lock

NOTE:

- Factory default fingerprint database is empty, any fingerprint can open the lock
- Wrong: Buzzer gives out di... di...di... sound
- Low voltage red indicator light is on, means too low voltage.

3

Introduction

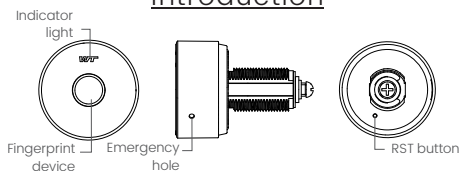

Install/replace battery

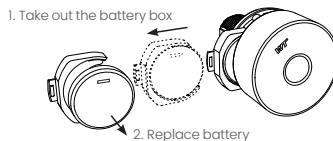
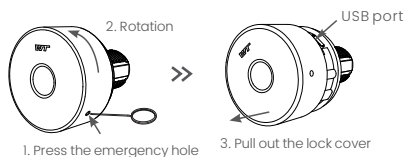

2

Setting

➤ How to add the management fingerprint add management fingerprint (there are 2 ways)

One way:

- 1> When the fingerprint database is empty , put the fingerprint on the lock for about 1s, you will hear a long di sound with green light on; again put the management fingerprint on the lock for about 3s, you will hear two short di sound with green light  flash, now you are ready to add management fingerprint.

The other way:



- 2> Press the RST button,you will hear a long di sound with green light  flash, now you are ready to add management fingerprint. To put the management fingerprint on the lock for 3 times, you will hear a short di sound means inputting fingerprint succeed, if you hear three short di sound, means failed. Then change position of fingerprint and press 3 times successfully, a long di sound alarm, means means setting management fingerprint succeed.

NOTE:

- Management fingerprint have add and delete user fingerprint function.

4



How to add the user fingerprint

- 1 - Put the management fingerprint on the lock for about 1s, you will hear a long di sound with green light  on
- 2-Again put the management fingerprint on the lock for about 1s, you will hear two short di di sound with green light  flash, now you are ready to add user fingerprint
- 3-To put the user fingerprint on the lock for 3 times, you will hear a short di sound means user fingerprint setting succeed, if you hear three short di sound, means failed. Then change position of fingerprint and press 4 times, a long di sound alarm, means succeed. (8 at most)

NOTE:



A maximum of 8 user fingerprints can be added.

How to delete all user fingerprint

- 1 - To put the management fingerprint on the lock , you will hear a long di sound with theunlocking indicator light  on
- 2-Again put the management fingerprint on the lock , you will hear two short di di sound with the unlocking indicator light  flash
- 3-put the management fingerprint third time on the lock , you will hear a long di sound , now all user fingerprints were deleted

5

How to delete all fingerprint

- 1 - To put the management fingerprint on the lock , you will hear a long di sound with theunlocking indicator light  on
- 2-Again put the management fingerprint on the lock , you will hear two short di di sound with the unlocking indicator light  flash
- 3-Put the management fingerprint third time on the lock , you will hear a long di sound , and again put the management fingerprint on the lock for 3s; now all fingerprints were deleted.

How to switch the working mode between private mode and public mode

Take out the battery and then put the pin into the reset hole, at the same time equipped with the batteries:

- 1.Release the pin when you hear the long sound of di, means private mode setting succeed
- 2.Release the pin when you hear three times of long sounds di di, means public mode setting succeed.

Note:

after switching the mode, the management fingerprint is still valid management fingerprint can unlock in both two modes

6

Fixing hole size

>Fixing hole size Unit : mm

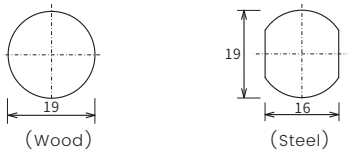

> Installation

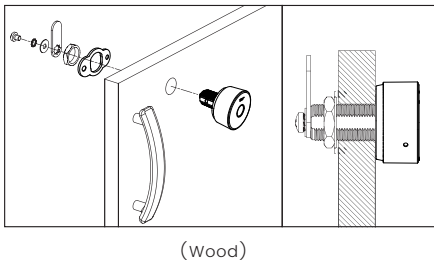

(Wood)

7

Features

> How to reset

Put the pin into the hole at the back side of lock when you hear a short di sound means lock reset without unlocking .

> Automatic power shortage prompts

When red indicator light on means battery is in low voltage, please replace the battery.

Noted: the lock may not work if the voltage is too low.

> Emergency power supply

The lock can't be operated when the voltage is very low, power bank can be the emergency power supply.

Technical parameters

Fingerprint device	Semiconductor fingerprint reader	Management fingerprint	2
Working temperature	-20~+55°C	User fingerprint	8
Working humidity	10% ~ 85%	Static current	20uA
Storage temperature	-40 ~ +55°C	Dynamic current	30mA
Power supply	Cr2450	Batteries life time	1 year

8