

ROD-LATCH SYSTEM

MODULER SYSTEM SWINGHANDLE

407

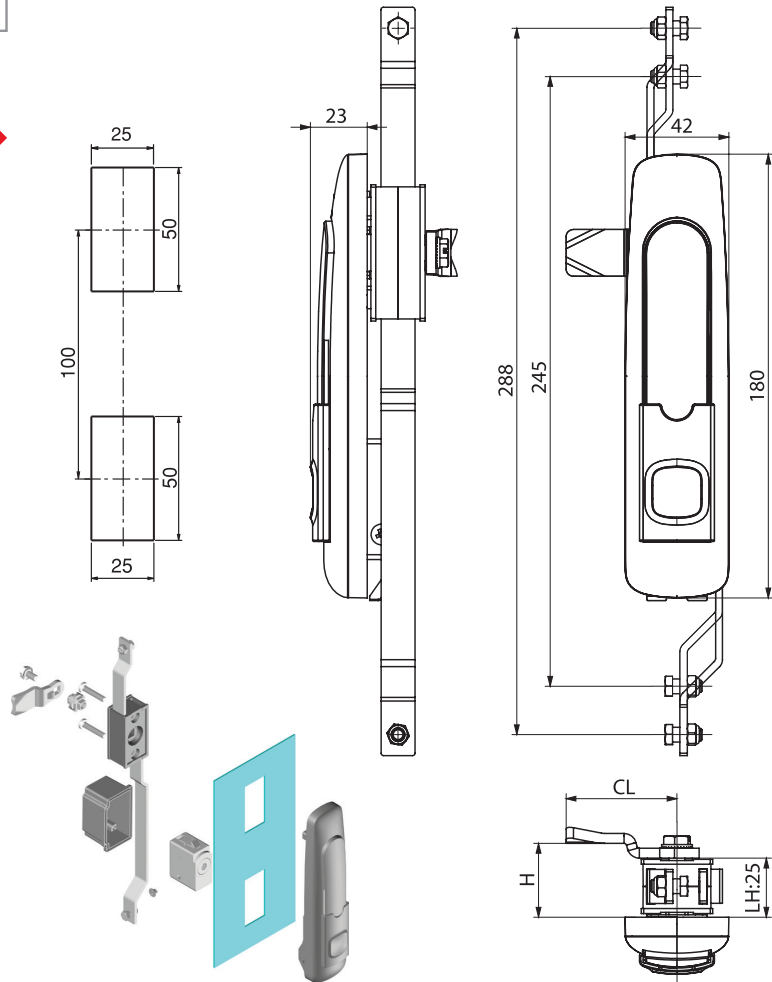

- Swing handle has a modular lock structure allows easy modification for customer requests
- Lock and modules could be ordered separately
- Single point locking and gearbox option is possible on same lock by an adaptor
- Padlock is optional
- Easy fixing option by plastic clips

MATERIAL

BODY: PA6 GFR 30
HANDLE: Zamak DIN-EN 1774-ZnAl4Cu1
MECHANISM: PA6 GFR 30
MODUL: Zamak DIN-EN
CAM: Steel

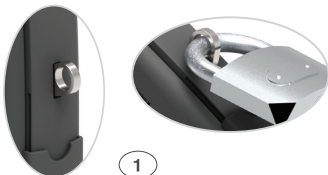

1
Padlock application

 For cams please check pages: 172 - 173

 For rods please check pages: 178 - 188

 For keys please check pages: 189 - 191

PRODUCT CODE

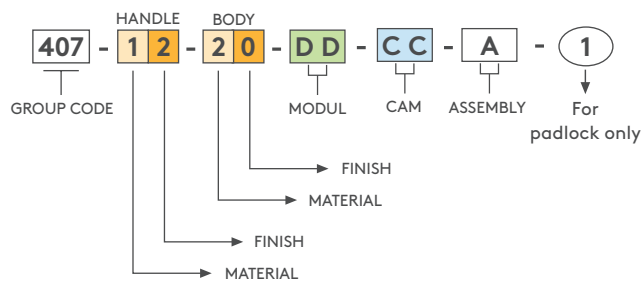

MATERIAL	M
Zamak	1
Plastic	2

FINISH	F
No finish	0
Black coated	2

CYLINDER TYPE	DD	Order code
Stainless steel dust cap (Keyed alike)	03	MDL03
Stainless steel dust cap (Keyed differ)	32	MDL32
Euro key (5333)	05	MDL05
CH751 (Stainless steel dust cap)	07	MDL07

DRIVERS	BUTTON	CYLINDER
5 mm Double bit	Zamak	Brass
8 mm Square		
9 mm Triangular		
15	55	11
MDL15	MDL55	MDL11

Due to the modular structure, the swing-handle can be easily modified to the desired locking system

Modules can be ordered separately.

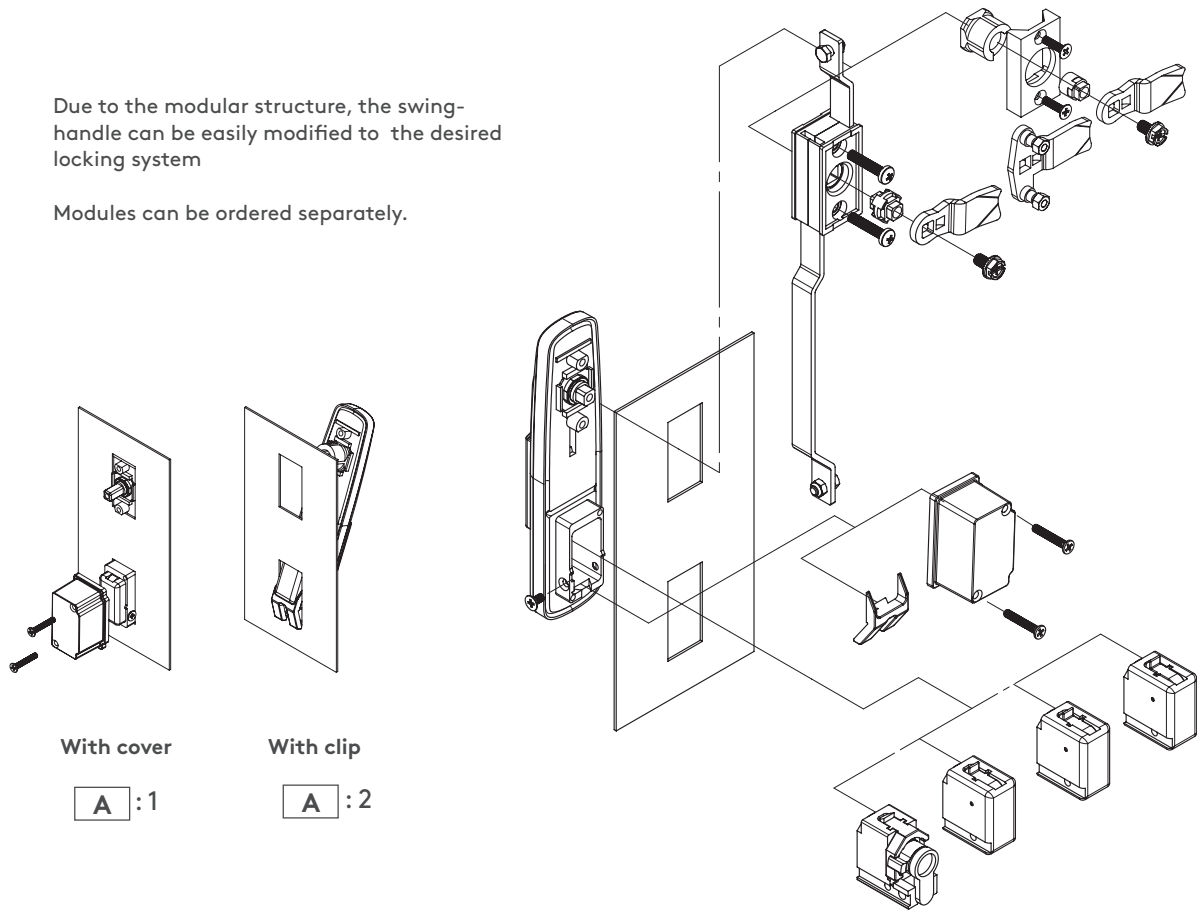

With cover

A :1

With clip

A :2

The set items can be ordered separately with their codes in below

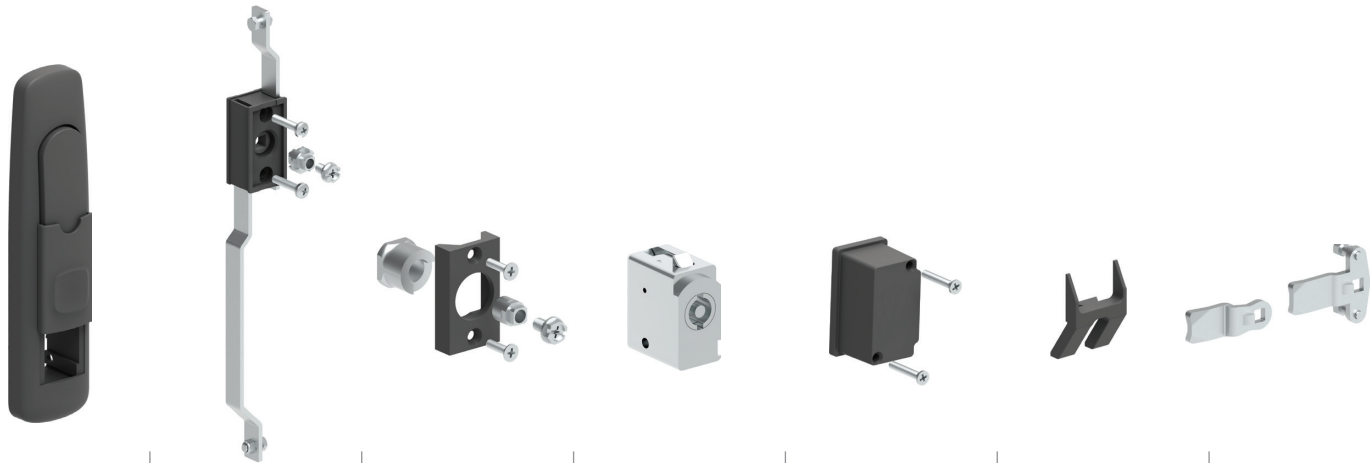

MLS01	MLS02	MLS03	MDLXX	MLS05	320.02.246	CAMS
1-SET:	1-SET:	1-SET:	MODULES	1-SET:	1-PCS	
<ul style="list-style-type: none">• Body• Handle• Dust cap• Shaft	<ul style="list-style-type: none">• Plastic Mechanism• Screws• Cam Adapter	<ul style="list-style-type: none">• Plastic Fixed Part• Screws• Cam Adapter	<ul style="list-style-type: none">• MDLXX	<ul style="list-style-type: none">• Plastic Fixed Part• Screws	<ul style="list-style-type: none">• Clip-in part	
	For multi point locking	For single point locking	Please check the previous page	With this set the handle meet IP 65 specs.	With this clip-in part mounting time reduces by %50	Please check the cams page 172 - 173